

Przejście szczelne dla rur GFK/GRP SN 10000

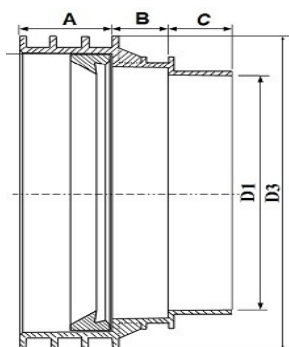

Materiał: PP

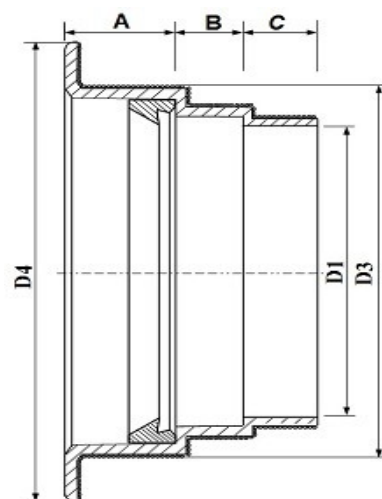

Materiał: GRP

| DN | D1 ± 2 | D3 ± 10 | D4 ± 10 | A ± 10 | B ± 10 | C ± 20 | Material |
|------|-----------|------------|------------|-----------|-----------|-----------|----------|
| 150 | 159 | 210 | 262 | 68 | 41 | 45 | GRP |
| 200 | 208 | 279 | | 65 | 40 | 45 | PP |
| 250 | 259 | 316 | 385 | 70 | 40 | 45 | GRP |
| 300 | 310 | 370 | 420 | 70 | 39 | 41 | GRP |
| 350 | 360 | 415 | 480 | 70 | 40 | 45 | GRP |
| 400 | 410 | 470 | 530 | 70 | 41 | 39 | GRP |
| 450 | 453 | 518 | 578 | 71 | 38 | 41 | GRP |
| 500 | 505 | 570 | 635 | 70 | 40 | 44 | GRP |
| 600 | 588 | 660 | 720 | 70 | 42 | 38 | GRP |
| 700 | 690 | 762 | 828 | 60 | 50 | 40 | GRP |
| 800 | 786 | 866 | 940 | 60 | 50 | 40 | GRP |
| 860 | 824 | 913 | 1001 | 60 | 40 | 45 | GRP |
| 900 | 889 | 965 | 1065 | 68 | 43 | 67 | GRP |
| 1000 | 985 | 1075 | 1155 | 60 | 50 | 60 | GRP |
| 1100 | 1087 | 1172 | 1250 | 70 | 40 | 55 | GRP |
| 1200 | 1180 | 1278 | 1405 | 70 | 75 | 55 | GRP |
| 1300 | 1279 | 1392 | 1477 | 70 | 60 | 45 | GRP |
| 1400 | 1371 | 1495 | 1585 | 70 | 60 | 55 | GRP |
| 1600 | 1556 | 1705 | 1850 | 70 | 70 | 135 | GRP |

Materiał: PP – polipropylen

GRP - żywica poliestrowa nienasycona zbrojona włóknem szklanym z dodatkiem wypełniacza.

Aprobata: Instytut Badawczy Dróg i Mostów Nr. AT/2011-02-2770/1